

NOTES

- ZONING: RESIDENTIAL RURAL, SINGLE FAMILY - MIN LOT SIZE: 1 ACRE, 40,000 S.F. CONTIGUOUS FRONTAGE: 150'. BUILDING SETBACKS: FRONT: 25', SIDE: 15', REAR: 15'. WATER: 50'. WETLANDS: 50'
- TAX MAP & DEED REFERENCE: MAP R15 LOT 6 DEED: S.C.R.D. 3693-0094 TRACT II... TOTAL AREA: 431,255 S.F. - 9,900 ACRES
- OWNER OF RECORD: THOMAS E. & MICHELLE P. HUCKINS, 262 CHESTNUT HILL ROAD, FARMINGTON, N.H. 03835
- TYPE OF SURVEY: THIS IS A "U" CLASS SURVEY COMPLETED BY A RANDOM TRAVERSE HAVING A RELATIVE ERROR IN CLOSURE 1 IN 10,000 WITH A TOPCON GTS-304 TOTAL STATION AND A RANGER DATA COLLECTOR
- FIELD CREW: R. ORVIS, B. COTE Jr., F. JEWELL
- FIELD BOOK: # 45
- BEARING OBSERVATION: PER PLAN REFERENCE #1
- FLOOD HAZARD: NONE PER FEMA / FIRM COMM-PNL 33017C-01820 EFF. MAY 17, 2005
- BURIAL GROUND: NONE OBSERVED

REFERENCES

- "PLAN OF LAND, FARMINGTON, N.H. FOR ARLENE GLIDDEN" BY: NORWAY PLAINS ASSOCIATES, INC. DATED: JULY 1993. S.C.R.D. PLAN 43-39
- "SUBDIVISION OF LAND AND COMPASS & TAPE BOUNDARY SURVEY FOR THOMAS B. & VERNA MAE COPP IN FARMINGTON, N.H." BY: BRUCE L. POHOPEK DATED: NOV 28, 1993, REVISED 7/6/84 S.C.R.D. PLAN 24A-83

REVISIONS

REV # 0 - INITIAL DRAWING

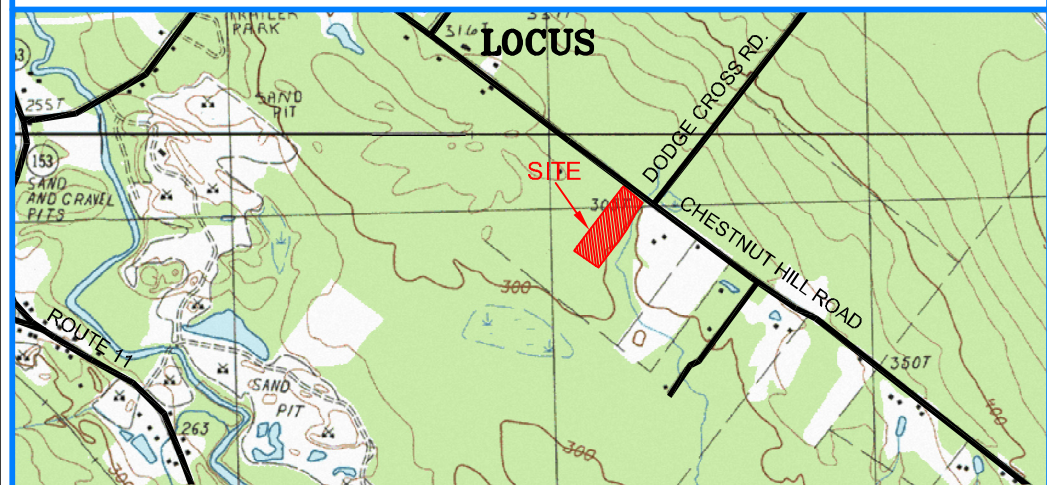

EXISTING CONDITIONS PLAT
 TAX MAP R15, LOT 6
 CHESTNUT HILL ROAD
 FARMINGTON, STRAFFORD COUNTY
 NEW HAMPSHIRE
 PREPARED FOR
THOMAS E. & MICHELLE P. HUCKINS

APPROVED
FARMINGTON, NH PLANNING BOARD

THIS SURVEY WAS PERFORMED BY ME OR THOSE UNDER MY DIRECT SUPERVISION.
RANDY R. ORVIS L.L.S. #652
 P.O. BOX 277
 FARMINGTON, N.H. 03835

DATE: _____
 CHAIRPERSON: _____

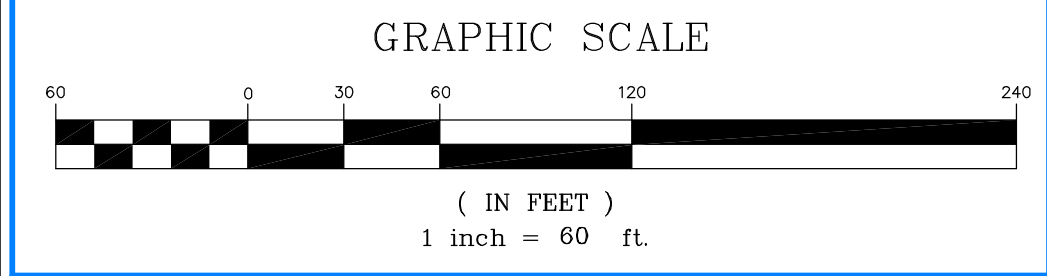

JUNE 5, 2009 SHEET 2 OF 6 PLAN # 1139

Geometres Blue Hills, LLC

LAND SURVEYING
 LAND USE CONSULTING
 SEPTIC SYSTEM DESIGN
 ENVIRONMENTAL CONSULTING

PO BOX 277
 HORNETOWN ROAD
 FARMINGTON, NH 03835-0277
 603-859-2367

SOIL SURVEY OF STRAFFORD COUNTY, NEW HAMPSHIRE
 SHEET 12, ISSUED MARCH 1973
 SCALE 1"=20,000'

GsB GLOUCESTER VERY STONY FINE SANDY LOAM, 3 TO 8% SLOPES.
 HaB HINCKLEY LOAMY SAND, 3 TO 8% SLOPES.
 LrA LEICESTER-RIDGEBURY VERY STONY FINE SANDY LOAMS, 0 TO 3% SLOPES.

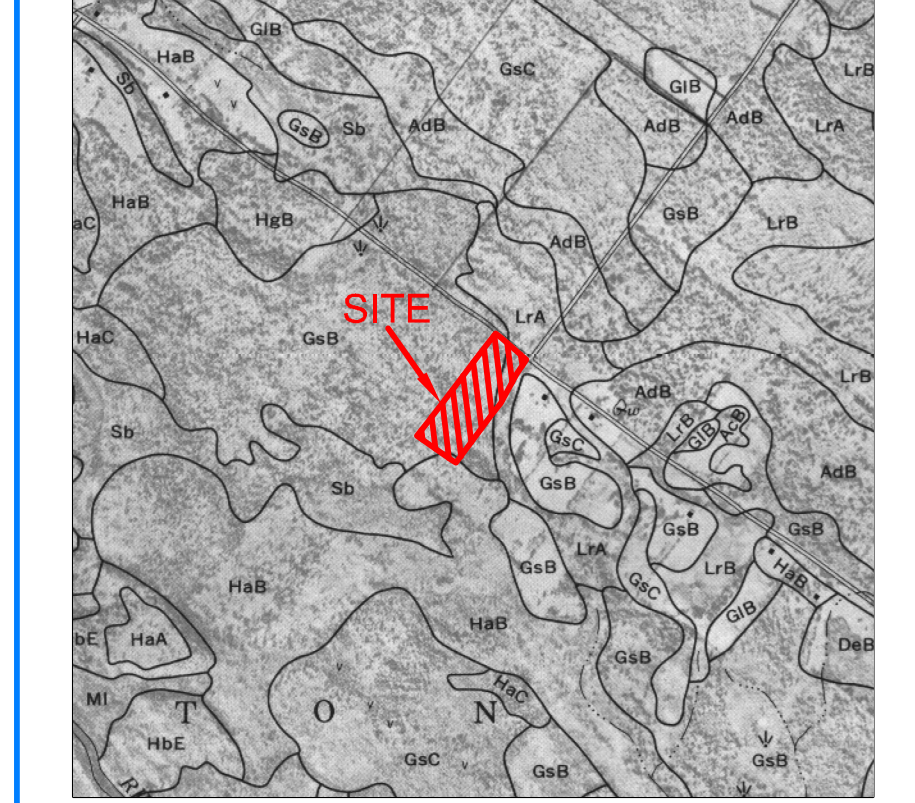

LEGEND

- DRILL HOLE FOUND
- REBAR FOUND
- X POINT OF DEFLECTION
- UTILITY POLES
- IRON PIPE FOUND
- - - SEPTIC SETBACK
- - - BUILDING SETBACK
- - - SIDEWALK EASEMENT
- - - STONEWALL - SUBJECT
- - - STONEWALL - ABUTTOR
- WETLAND
- ▲ REBAR WITH I.D. CAP #652 TO BE SET